

Congratulations on your purchase of Protectus

You have made an investment that we are confident will improve your listening experience and bring you joy for many years to come.

How it works

Protectus dampens negative effects in sound reproduction through its construction of cross-laminated wood and a mix of various metal beads, addressing both mechanical vibrations and micro-vibrations caused by electricity and magnetism.

What truly sets **Protectus** apart from other vibration-dampening products is our metal mix, which works to affect high-frequency electromagnetic fields surrounding your components whilst also allowing you to drain away high-frequency currents that otherwise circulate within the chassis, causing high-frequency magnetism.

Protectus significantly enhances sound reproduction simply by being placed under your device. To fully utilise this product, we recommend connecting the included **Eartha Ground Cable** to the chassis of your component. This allows both micro-vibrations and high-frequency currents from the chassis to drain into the metal mix of **Protectus** via the cable.

Getting started

1. Unbox your **Protectus**, turn it upside down and apply the four **cork feet** to each corner of the base.
2. Flip **Protectus** over. Power down your equipment and disconnect from the mains.
3. Place your **Protectus** on your equipment support and place your component on top of **Protectus**.
4. To ground the chassis of your component you can either; **a.** loosen a screw on the back or bottom of the chassis, attach the **V-hook** of the **Eartha** cable and re-tighten the screw for a direct connection. **b.** loop the hook of the **Eartha** cable around the latch of an XLR input for solid contact with the chassis or **c.** attach the **Q fix** by peeling off the protective paper and firmly pressing the **Q fix** onto a clean screw or metal surface on the back or bottom of the component then attaching the **V-hook** of the **Eartha cable** to the loop of the **Q fix**.
5. Attach the other end of the **Eartha cable** to the ground post on the rear of **Protectus**.
6. Switch on your equipment and enjoy!

Warning

Protectus is designed for chassis grounding *only*. Do not connect **Protectus** to signal ground via any of the signal connectors. For signal grounding, we recommend using an **Entreq Ground Box** from the **Tellus** or **Olympus** ranges along with an appropriate **Eartha Ground Cable**.

Contents



1 x Q fix



1 x Eartha Cable

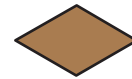

4 x Cork feet

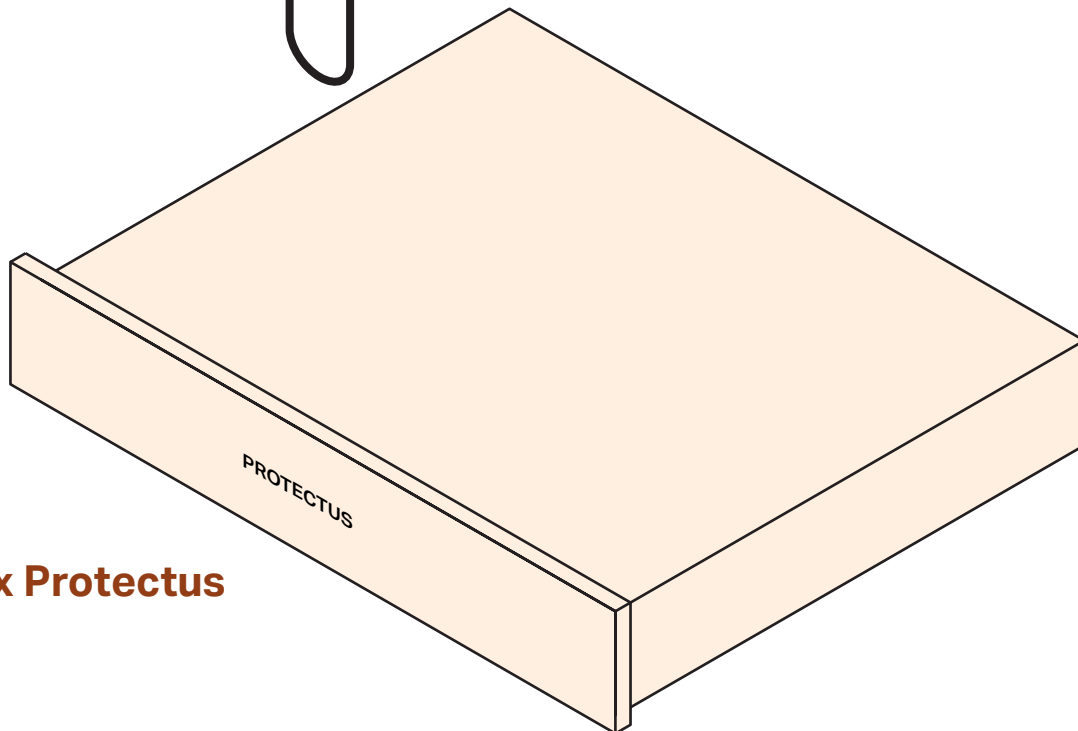

1 x Protectus

Set up

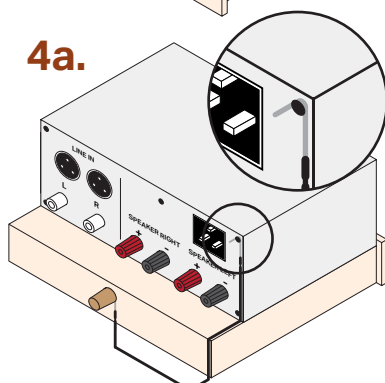
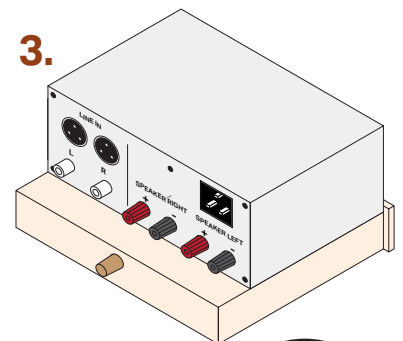
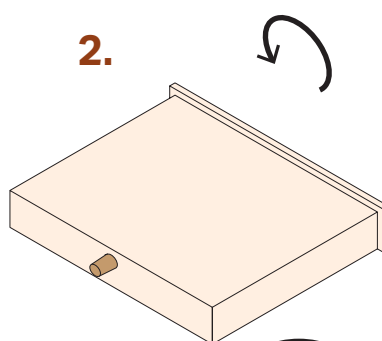
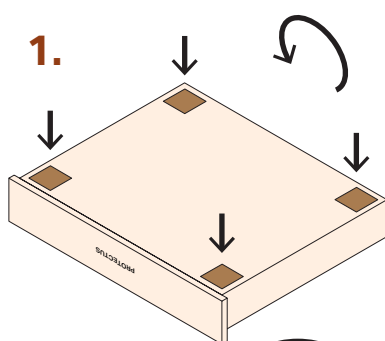

Screw method

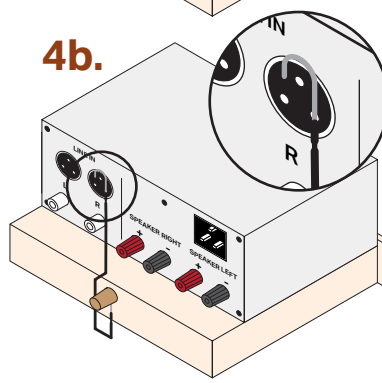

XLR method

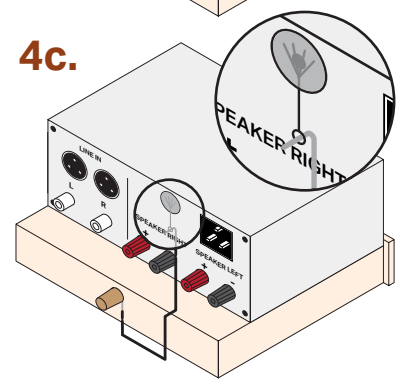

Q fix method